

# JARDÍN-TERRAZA

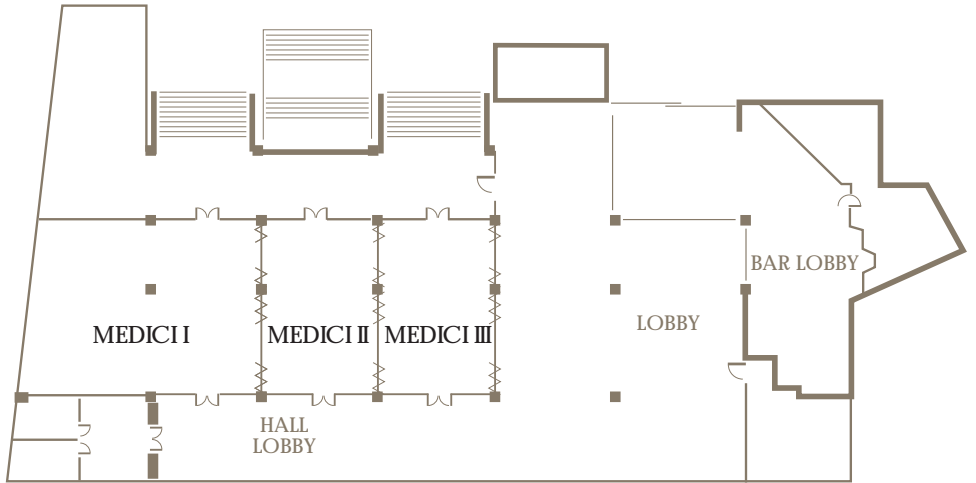

LUZ  
NATURAL



SALIDA  
JARDIN

MEDICI I	SI	100	100	35	70	100	140	270 / 250	SI
MEDICI II	SI	50	50	25	40	60	72	270 / 250	SI
MEDICI III	SI	50	50	25	40	60	70	270 / 250	SI
TOTAL		200	200	70	150	250	288		